



archdeacons'

visitation news

Spring 2015 - issue 2

Dear friends...

Bishop Nick, our Diocesan Bishop, has written this introduction to this year's Archdeacons' Visitation News:



Churchwardens stand at the heart of the Church of England's parochial mission.

A bold statement – merely intended to flannel and cajole? No, I mean it. Let me explain why.

Churchwardens take responsibility for buildings, finance and the running of the church for the sake of the parish. Our buildings are not bit-part players in the Church's mission, but tell a story to the world outside about who we think we are, who we are for, and what we think of God. In other words, they have an evangelistic function and are more than (sometimes problematic) bits of fabric.

This means that, working with clergy and other ministers, churchwardens need to be able to look at the 'stuff' of the church through the eyes of those who only see the building from the outside. Do the noticeboards tell a story to those who pass by or are they aimed at insiders only? Do they show images of what happens inside the building? Do they speak of who the church is for and what its ultimate purpose actually is? Or do they say we simply don't really care if people come or not?

Now, I am not naïve. Many of our church buildings are hard to maintain, hard to heat,

and hard to finance. They can be a drain on what we see as our basic vocation – to create a space in which people can find that they have been found by God. Some buildings won't survive the next decades and we need to have the courage to invest in what can grow, rather than what will drain the resources of their last generation.

The Diocese of West Yorkshire and the Dales has been established partly in order to help us focus afresh on our core mission. The hard questions of sustainability and growth are not ones we can – or should want to – duck. So we shall be working together – mainly through our episcopal areas and led by the area bishops – to grasp the nettles that might set us free for the future.

I am extremely grateful for all that our churchwardens do, both in and beyond the church itself. The investment of time, energy, commitment and vision is huge – and testament to the seriousness with which the local church takes its responsibility for its wider community. We are here to serve and reach out to those among whom God has put us, and we are called to be faithful in exercising this responsibility.

As we shape the central diocesan resources for mission and ministry in this first full year of our diocesan life together, we may do so with vision, courage and confidence. And churchwardens will be at the heart of it all.

+ Nick



Bradford
The Venerable
Dr David Lee



Halifax
The Venerable
Dr Anne Dawtry



Leeds
The Venerable
Paul Hooper



Pontefract
The Venerable
Peter Townley



Richmond/Craven
The Venerable
Paul Slater

Churchwarden training 2015

Bradford: 11 July 2015, 9.30am

Churchwarden training for all – Venue TBC.
3 October 2015, 9.30am Churchwarden training for all – Venue TBC.

Huddersfield: 30 June 2015, 7.30pm

New churchwardens – Huddersfield, Holy Trinity.
30 September 2015, 7.30pm Experienced churchwardens – Halifax, All Saints.

Ripon: 13 June 2015, 10am

Churchwarden training for all – Colburn Church Hall, Catterick.
19 September 2015, 10am Churchwarden training for all – Christ Church, Skipton.

Leeds & Wakefield: 1 July 2015

New churchwardens – St Andrew, Morley.
8 October 2015, Experienced churchwardens – St Andrew, Morley. Buffet Supper served at 6.45 pm; Session commences 7.30pm.

Archdeacons' contact details

Bradford Archdeaconry:

The Ven. David Lee – 01274 200698
david.lee@westyorkshiredales.anglican.org

Halifax Archdeaconry:

The Ven. Dr Anne Dawtry – 01484 714553
archdeacon.halifax@westyorkshiredales.anglican.org

Leeds Archdeaconry:

The Ven. Paul Hooper – 0113 269 0594
paul.hooper@westyorkshiredales.anglican.org

Pontefract Archdeaconry:

The Ven. Peter Townley – 01924 434459
archdeacon.pontefract@westyorkshiredales.anglican.org

Richmond/Craven Archdeaconry:

The Ven. Paul Slater – 01535 650533
paul.slater@westyorkshiredales.anglican.org

Produced and printed by



Serious lead theft at St Augustine's Scissett



On 18 October, thieves got onto the roof at St Augustine's Scissett in the Dearne Valley and stripped all the lead from the valley gutters. In doing so they also damaged about a metre depth of tiles along the

length of the church. Water quickly came in and damaged the plasterwork and the electrics inside the church. The result was over £50,000 of damage. The advice from the architect was that because of falling plaster and loose tiles on the roof, the church would have to temporarily close. This was devastating news to many in the community and to the parish. Raising such a sum seemed impossible for the congregation alone. At this point in time (see the article opposite about Ecclesiastical now extending lead theft cover from February 2015) insurance cover was only available for £5,000 towards the lead replacement and £5,000 towards repairing internal damage.

But then expressions of support began to come in. The local nursery school did a sponsored walk, with the children raising £437. The first school made a Christmas CD which brought in nearly £700. Two weeks ago there was further good news that the church, originally excluded from applying for the Listed Places of Worship Roof Repair Fund, was now able to make an application due to a change of policy after extensive lobbying. Of course, there are no guarantees that they will get that grant – and much community consultation about the future of St Augustine's still needs to happen. Yet there is hope – hope that might not just lead to repair of the roof, but might also mean new beginnings for the church, congregation and community.

The Ven Dr Anne Dawtry and The Revd Joy Cousans

Lead theft cover: insurance update

During 2014 Ecclesiastical carried out a listening exercise with parish and diocesan representatives in a number of dioceses throughout the country to hear their views on the issues they faced and how they might be able to assist. These discussions have continued and have included key members of various committees of the Church of England.

One of the main topics was the issue around theft of metal and how best everyone could work together to provide further support and assistance to churches, notwithstanding the very serious losses that have arisen over the past few years. Following detailed investigation, Ecclesiastical is now able to further assist and protect churches by increasing the limits under their Parishguard policy in respect of the theft or attempted theft of external metal and subsequent damage arising from the theft or attempted theft of external metal.

Ecclesiastical will shortly be communicating with all parishes that hold a Parishguard policy about these changes which apply from **1 February 2015**. The basic changes are as follows:

- for parishes where there is compliance with the SmartWater conditions, cover will be increased from £5,000 to up to £7,500 both for the initial lead theft and for any subsequent damage
- for parishes that have a roof alarm as well as comply with the SmartWater conditions, cover is being increased from up to £10,000 for the initial lead theft and up to £10,000 for subsequent damage to up to £25,000 for both lead theft and subsequent damage. Conditions relating to the roof alarm do however apply
- for parishes where scaffolding was erected at the time of the lead theft,

even where the SmartWater conditions and roof alarm conditions had been met, no cover was previously provided. However now, provided these churches have complied with suitably agreed security arrangements, cover of up to £25,000 for both the lead theft and subsequent damage now applies.

Even better news is that in all cases no additional premium is payable. This will be of great help to all churches that have suffered from lead theft. In all cases cover is increased, and it is increased significantly for churches with roof alarms.

Ecclesiastical appreciates that in a limited number of cases there will still be churches that require cover for theft of external metal in excess of the revised limits that are now being offered. It is therefore continuing to explore how it can assist churches that have an Ecclesiastical-approved roof alarm and meet the SmartWater conditions so that they can purchase a 'top-up cover', at an additional premium, to meet their own bespoke requirements.

If you have any queries regarding these changes, please do not hesitate to call Ecclesiastical on **0845 777 3322** or email **churches@ecclesiastical.com**

Michael Angell – ACII Chartered Insurer, Church Operations Director, Ecclesiastical.

(Edited by The Ven. Dr Anne Dawtry – Archdeacon of Halifax).

Consulting with the Church Buildings Council as part of the faculty process

When a parish submits a faculty there is often consultation needed with the amenity societies, English Heritage and the Church Buildings Council – as per the section on the faculty form (Form 3A page 4 section F9: Consultation for works of alteration to the exterior or interior of a listed church).

There is a new guidance note on 'When to consult the Church Buildings Council' which takes into account changes introduced in the new Rules (2013) and replaces earlier guidance.

The guidance is available here: http://www.churchcare.co.uk/images/Churches/When_to_consult_the_CBC_Jan_2015.pdf and the page that it links to is: <http://www.churchcare.co.uk/churches/church-buildings-council>

It will be of great assistance to the council, and to the statutory consultees, if you could include a ground plan and interior and exterior photos (as recommended in the guidance) when you prepare your Statements of Significance and Need.

Please do contact the assistant DAC secretaries if you have any queries on this process and are thinking of applying for a faculty so that the consultation process can begin at the most appropriate point.





Welcome and hospitality – A tale of two churches...

Romaldkirk is a village towards the north of our diocese in the Ripon episcopal area, very close to the boundary between the Dioceses of West Yorkshire and the Dales and Durham. The church, which is open during the day, is dedicated to St Romald and is a Grade I listed building. The electoral roll is 52. The congregation wanted to make the building more welcoming to those worshipping as well as to visitors attending various community events in the church.



After due consideration, it was decided that a disabled access toilet and a small kitchen were essential if the church was to develop its welcome. They consulted with the DAC and other interested parties at an early stage and from there worked out the brief for their architect. The new facilities were to be built at the base of the tower. They began thinking of the work in 2012 and completed the project in late 2014 at a cost of £60,000. They are very pleased with the way it is already helping the church building to be used more by the local community. The planning and fundraising work was undertaken by a very small group in the parish who raised funds through grant-making bodies as well as the congregation and wider community.

And a further spin-off – what has been achieved is also now inspiring one of the other churches in this group, Startforth, to look at doing something similar!

Roundhay, St Edmund

St Edmund's is a suburban church in north Leeds, with an electoral roll of 170. The congregation used part of the north aisle for serving refreshments on trestle tables, requiring the use of a hot water urn. The latter had Health & Safety implications for those serving refreshments. It also made the area around the entrance look messy to visitors. With this in mind, the PCC consulted with the DAC at an early stage with their architect and drew up plans in 2012, which also included the provision of two extra lavatories. A faculty was agreed and the work completed in 2014 at a cost of £55,000. The parish is pleased with the result and feels that it has enhanced the building in appearance as well as improving the service offered to both congregation and visitors. The church is used by many groups for concerts and community activities, including the Roundhay Arts Trail, which uses the church as a 'hub' for refreshments. The facility has also proved useful for the prayer breakfast held in the church.



Peter Mojsa
Former Assistant DAC Secretary

How welcoming is your church?

Here are a few suggestions to consider in order to make your church more welcoming to worshippers, visitors and any user of the building:



- make your signs clear about when the church is open and who to contact
- make it clear how to get in – a simple sign with an arrow to show where the entrance is
- have an attractive noticeboard to catch people's attention as they pass
- say who you are by displaying photos inside of the congregation while in a service, the church family and examples of the type of activities that take place
- be an open church – we work on the principle that ALL churches should ideally be open. We can work with Ecclesiastical to provide guidance on the best and safest ways to keep your churches open. Although some items may be stolen, it must be considered that to close the church except for services takes the building away from the community it serves
- some churches say "Come on in" just by having a glazed attractive entrance so people can see inside and look at what happens there
- first impressions count, so take care of your building – remove clutter and keep it clean, add some flowers and leaflets
- a visitor should feel that you have been expecting them and have made an effort
- give your visitors the opportunity to find out about the Christian faith by signs, books and leaflets, and by having people around to talk to – that is why the church is there!

Sylvia Johnson
DAC Secretary (from 1 April 2015)

Wakefield Episcopal Area:



The Venerable Peter Townley has identified three very different, but successful, examples of churches in the Pontefract Archdeaconry that are reaching out in different ways into their communities.

Peter.

The Well at All Saints Normanton

A number of years ago, All Saints Normanton was left a large legacy. They decided to use it to finance four projects to bless the community: a base for their community project – The Well; a school building in Africa; an amount to provide bibles to all the leavers each year from the Church school, and an education project (TLG) working with children on the verge of exclusion from secondary school.

Several years on, all the projects continue, though not without the challenge of finding continuation funding. The work is important though: the crime statistics on the sink estate, where the community centre is situated, are drastically down. The local paper has reported several times on the influence of The Well. Several students who were heading nowhere are now in tertiary education and thriving because of TLG. For 85% of the students, the project has been life changing.

The Well in particular has gained the church a huge amount of goodwill within the local community. So much so that we were recently approached by the local council and asked if we would like to take on a second building in the local park for youth outreach. After discussions, we expanded the brief and in July 2014 we were handed a 30-year lease to a newly refurbished community building, along with two smaller units, which in November became the storerooms for the latest Trussel Trust foodbank and a clothing bank. What has surprised us most has been the number of non-churchgoers who have volunteered to help with the foodbank in a variety of capacities.

All of these projects have taken the church out of itself and into the world, while occasionally the flow is the opposite way round and we are told 'the angels rejoice'.

Alan Murray



Castleford team parish family and children's work

Selling a plot of land upon which the old St James Mission Church stood became a time of liberation for us. In a parish like Castleford, it would have been easy to use the money to upgrade the buildings, but instead we earmarked the money to employ a family worker to organise activities across the parish including an 'Infant Harmonies' group.

Within days we had four parent and toddler groups up and running, some of which became over-subscribed almost instantly. During school holidays there are regular themed activity days and the pancake and bonfire parties are essential places to be seen at for the young people as well as members of the congregations.

At the end of the Toddler Nativity service, Father Christmas arrived on a lorry (miniature that is), which the children could then have rides on. We have also had visits from the police and fire brigade to help build up relations.

We are now in touch with something like a hundred families and Karen, our worker, also meets all of the families who come to book baptisms. Karen is invited to local family centre liaison meetings and is in touch with many of the local schools, all which shows that she and our work is valued and accepted in the wider community.

The Revd Michael Wood

Mission to the community at Cudworth



Since the blessing of the new parish and community hall in 2012, this addition to the plant at St John's has been an immense blessing in our outreach and mission to the community of Cudworth. We are able to host a drop-in baby group every Wednesday, which has brought about several baptism enquiries

and given us an opportunity to meet with young families. The Brownies meet here every Thursday and come to mass several times during the course of the year; in Advent we hosted the Christ the King Group advent course, attracting over 40 people each Sunday. The hall is used by bereaved families after funerals, by baptism parties, by the schools – it has opened up a whole new world for our parish. The diocese has used it for an evening to help parishes access the Big Lottery Fund; we were able to offer the church and hall to our Roman Catholic neighbours to help celebrate their priest's silver jubilee, which was a wonderful occasion and then led to ecumenical study groups held each month. It has also given the parishioners a place where they can meet after mass, have parish dinners, and other events to raise the profile of the church in this community.

David Nicholls

Church Insurance Made Simple

We've been talking to you, our customers, over the last year to find out how we can help make it easier for you to understand your insurance cover. Thanks to what you have told us, we have now developed a new series of 'Made Simple' documents to help you with key topics where you wanted straightforward, easy-to-follow, advice.



The new guides are available to read or download from our website. Each provides a simple summary of a topic together with links to web pages and other documents that include more-detailed information.

For those of you looking after your church insurance, we now have a simple guide to administering your policy. This includes help and advice on paying premiums and ways you might save money, including interest-free direct debits or increasing the excess on your policy (the amount you pay if there is a claim). It also explains when you need to tell us about changes or activities at your church.

In addition we have also produced the following 'Made Simple' guides:

Church Buildings – an explanation of the insurance issues related to church buildings such as ensuring you have fire risk assessments and avoiding slips, trips and falls.

People in Church Premises – looking at health and safety and other matters to consider to help keep regular visitors to your buildings safe.

Events – from fundraising to Christmas services, a summary of what you need to know and when you need to tell us about events at your church.

Community outreach – churches increasingly offer services such as night shelters – here we summarise the main topics and what you need to consider with your outreach activities.

The 'Made Simple' guides reflect our desire to make sure that churches understand what is covered by their insurance and what is not. Plus we hope they will help to encourage churches to take simple steps to mitigate possible risks. The guides supplement the wide range of content we have on our Church Matters website. If you have any feedback on the new guides or ideas for topics we might cover, why not email us at churches@ecclesiastical.com with your thoughts?

All the new guides can be found at www.ecclesiastical.com/madesimple



National Crime Helpline for Churches

The Church Buildings Council has set up a national crime helpline for churches to use after a theft.

Once a theft is reported it will trigger an alert to auction houses, museums and crime prevention agencies which is a fast, effective way of preventing the sale and permanent loss of treasures. Both the Church Buildings Council and Ecclesiastical are keen that we can all enjoy the many treasures and artworks in churches. But, while the fear of crime is greater than the reality there is no room for complacency and we encourage churches to take simple security measures to protect their church contents such as marking metal items with SmartWater (see overleaf).

To report the loss of a treasure or artwork from your church contact the **Church Crime Alert team** on **020 7898 1860**, or email churchcrimealert@churchofengland.org. Visit www.ecclesiastical.com/churchsecurity for more information on keeping your church secure.



Top Tip...

If you feel your church should normally be kept locked, you might like to consider making the key available to visitors. You could ask a local shop, Post Office or garage to safeguard the keys and take details of those visitors who wish to use them. Information about where to obtain the keys can be displayed in the porch area or on the church notice board.



The Ongoing Fight against Metal Thieves

Top Tip...

SmartWater can be used on other items in addition to lead roofing – make sure you mark all church owned metals including memorial plaques as well as other valuables you may have inside your church such as silver, altar ware and valuable portable furnishings.

Ecclesiastical has led a concerted effort in recent years to make churches less-attractive targets for thieves by working with the Church of England, parliament and other interested parties to tighten up the law on scrap metal dealing and increase building security.

While we have seen a reduction in recorded theft of lead roofing, it is important that we remain vigilant as metal theft has not gone away. This is one of the reasons why Ecclesiastical is continuing its proactive work with SmartWater and the police to target metal thieves. We also continue to encourage the use of other security products such as roof alarms to protect churches.

are checking for SmartWater and refusing to buy anything marked with it then thieves will quickly learn there is no point in stealing it in the first place.

For this reason, it is very important that you continue to display SmartWater deterrent signs around your church. These should be placed in highly visible locations where would-be thieves are most likely to see them. **If you require new signage then please call SmartWater on 01952 204 102.** Remember, you will not be covered for metal theft or any subsequent damage as a result of theft or attempted theft of metal unless you have applied SmartWater (or an alternative forensic marker approved by us), displayed the signage, and registered the product.

One key aspect of the ongoing fight against metal thieves has been to target the scrap metal and recycling industries in order to make it more difficult for thieves to sell on stolen goods. In the last 5 years, our partners at SmartWater have made over 1,150 visits to scrap yards accompanied by regional police forces in proactive 'Days of Action' to search for SmartWater-marked metals.

A number of helpful crime prevention tips – including information about SmartWater and roof alarms – can be found on the Ecclesiastical website at www.ecclesiastical.com/theftofmetal

The purpose of these visits is to remind scrap dealers that they face being arrested and convicted of handling stolen goods if they buy SmartWater-marked metals. If scrap dealers



Man jailed for melting stolen lead

An Abergavenny man has been jailed after being caught with £3,700 of stolen SmartWater-marked lead from a church roof.

Jonathan Vaughn, 35, was caught after police received an anonymous call to say he was melting lead in his garden in St Llanfoist. When officers recovered the lead it was found to be marked with SmartWater traceable liquid. Subsequent analysis identified the lead as having come from St Mary's Church roof in Abergavenny. At Cwmbran Magistrates' Court, Vaughn admitted a charge of handling stolen goods. He was sentenced to four months for the offence and 113 days for a previous offence of assault after magistrates activated a suspended sentence. Mr Vaughn stated he had bought the lead to melt for Christmas money and refused to say where he'd bought it from.



COVER UPDATE



We have recently increased the maximum you may claim for theft of external metal – for more information see your next policy renewal pack. We are also now able to provide cover for metal theft when scaffolding is erected subject to certain conditions. For more information, visit www.ecclesiastical.com/theftofmetal or call **0845 777 3322**.

Allchurches Trust aims to raise giving to record levels

This January, insurer Ecclesiastical announced it had donated over £23m in 2014 to its charitable owner Allchurches Trust (ATL), a huge sum by any standard. But what is ATL and how does it use its resources to promote the Christian faith?



The charity, founded in 1972, is chaired by Sir Philip Mawer, former Parliamentary Commissioner for Standards and previously Secretary General of the General Synod of the Church of England. A career public servant, he remains closely involved with the work of the Church and its clergy.



According to Sir Philip, ATL's role is to support churches and other worthy causes linked to the Christian faith through a programme of financial grants. Over the last decade, it has donated over

£75m to projects as diverse as church building refurbishments and repairs, creating new facilities for people in need – even helping Anglicans in New Zealand establish a temporary cathedral following the devastating Christchurch earthquake.

In 2014 alone, ATL distributed grants of £9.7m, which went to a wide range of churches, dioceses and cathedrals throughout the British Isles. "ATL's mission is to promote and support the Christian religion," Sir Philip explains. "In broad terms, it does this by contributing financially to

charitable organisations and churches. Every month, we receive over 100 applications for grants, which are considered carefully by our trustees.

"Although the majority of our support goes to the Church of England, grants are also made in response to applications from ecumenical partner churches, church schools and charities. We particularly welcome applications from less well-off parishes and for projects which will benefit mission and help local communities."

Grants to parishes from ATL range in size depending on the scale of the project to be undertaken.

The prospects for ATL's activities are very positive based on Ecclesiastical's commitment to donate £50m during 2014-2016. "This is a hugely commendable ambition," Sir Philip notes. "What this means is that, given Ecclesiastical's solid financial performance and favourable conditions in the insurance market, we hope to be able to increase our giving to the Church to record levels over the coming three years."

For more information or to apply for a grant, visit ATL's website at www.allchurchestrust.co.uk, where full details are available.



St Giles Dell Centre, Ashted, Surrey

Ashted is about 15 miles from London, close to the M25 motorway. Faced with an old wooden church hall now well past its sell by date, members of the congregation have set about fundraising for new facilities.

Designs for the new Dell Centre include meeting rooms, a professional kitchen and a host of other facilities which the congregation envisage being used by the whole community. Pre- and after-school clubs, social gatherings, fitness, dance and art classes are all on their agenda, alongside mentoring job seekers, community support and activities for the elderly.

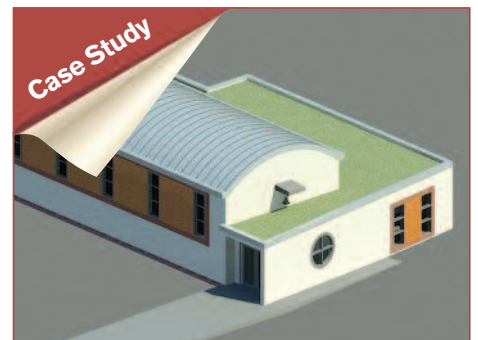

St Aidan's Church, Stobhill, Morpeth

St Aidan's is a modern church located in a deprived area on the outskirts of the market town of Morpeth, Northumberland.

With an outdated hall, the church was desperately in need of more community space. An exciting project was devised, resulting in the sale of the old church hall and the proceeds funding an extension to the church for community use. The new building will house a crèche, holiday clubs, a luncheon club and meeting rooms, and it can also be used to provide extra seating capacity for larger services, concerts and other events in the church.



Home insurance prize draw

Just call us for a quote or let us have your home insurance renewal date and we will enter you into a prize draw to win an iPad for you or your church. You can enter the draw by calling **0800 917 3345** and quote **IPAD15** or go on line at www.ecclesiastical.com/ipad

Top Tip...

If you are planning to support your community, for example, through providing a night shelter, food bank or parish nursing, there are important regulatory issues you need to be aware of. We can help you with free advice to make sure you comply with the regulatory requirements.



Independent Financial Advice

Do you need help with your finances? **Ecclesiastical Financial Advisory Services** can offer you totally independent financial advice on investments, retirement and protection. They can also help parishes who have funds to invest with their investment strategy. *Please note, the value of investments can fall as well as rise and past performance is not a guide to future performance.*

For more information call: **0800 107 0190** or email getadvice@ecclesiastical.com

Keeping up to date

We hope you are familiar with our Church Matters website which has a wide range of information, guidance and tools you can use to help you look after your church.

All our risk management guidance notes are collected together and sorted into the key categories of security, health and safety, fire, and storms and bad weather. Many customers also now get updates by email – just let us have your email address if you, too, would like to be updated in this way. For further information:

Our website:

www.ecclesiastical.com/church

Customer services:

call **0845 777 3322** or email churches@ecclesiastical.com

Claims:

call **0845 603 8381 (24-hour service)** or email faithclaims@ecclesiastical.com

Our customer service lines are normally open Monday to Friday, 8am to 6pm, except for bank holidays. However, claims can be registered at any time during the day or night.

Did you know?

Here we highlight two features of your Parishguard policy that you may not be aware of.

Consequential loss

Consequential loss cover is included in your Parishguard policy to help offset loss of income if your church has to close for repairs following insured damage that Ecclesiastical is covering under the Property section of your Parishguard policy. You may be able to claim up to £100,000 over a four-year period for loss of income from your normal church activities, such as service collections, income from hirers not being able to use the building and costs such as hiring alternate premises.

Money cover

The prospect of having money stolen by a church official or a volunteer is never an easy one for a church to contemplate, but sadly this is a risk that needs to be addressed.



In the last year there have been a number of court cases involving theft from church funds. For example, in 2014, a deputy church treasurer in the Wirral was found guilty of systematically stealing collection money for over a decade, amounting to almost £20,000.

The good news is that our Parishguard policy offers some protection against the risk of misappropriation. However, in order to meet the conditions of the policy and ensure that a claim can be defended, you will need to provide specific information and make certain that important checks are carried out. For example, regular reconciliations should be carried out of bank statements, cash-in-hand and petty cash, and these checks should be conducted by someone not usually responsible for money, so that thefts cannot be concealed during the reconciliation. **Our website has more information about how to limit the risk of internal fraud.**



Ripon Episcopal Area:

The Venerable Paul Slater, Archdeacon of Craven & Richmond, writes: Getting to know you... Getting to know all about you!

2014 was a year of getting to know many of the parishes in this new archdeaconry and to working with you all. I hope those in the Craven part did not feel neglected! It also turned out to be a year of lots of appointment processes of new clergy, and we have welcomed a good number of new people into the archdeaconry and diocese as well as seen some moves from within. Below are some of the faces of people who have been on the move this year.

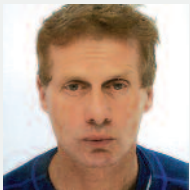

Jonathan Barker



Camilla Camplin Denton



Andrew Cromarty



Simon Dowson



Matthew Evans



Veronica James



Lynn Purvis-Lee



Jonathan Singh



James Theodosius



Alison Wallbank



Chrissy Wilson

As I have travelled around a lot, worked with you and listened to your hopes and concerns, a number of themes are beginning to emerge for me...

In many places, the Church is embracing its role as being at the heart of the community. It provides not only a spiritual focus of worship, prayer and pastoral care in the name of Christ but is also outward-looking, taking a lead in creating communities who care for each other and work together for the common good. This is exciting and exactly what Christ's Church should be about...

I am also very impressed by the quality of welcome to be found in many of our churches. I see churchwardens as key to creating a culture and atmosphere in the churches in which they serve, which speak of unfussy interest in newcomers and those who want to worship with us.

I have detected concern in some parts of the archdeaconry about the lack of resources to maintain a pattern of worship that is appropriate, not to say ministry in schools and pastoral care. It seems that our resources are inevitably rather unevenly distributed and Bishop James and I are beginning to get our heads around this. We have been encouraging churches to simplify (not reduce) their patterns of services, so that worship takes place at the same time each week if possible in a particular church rather than at different times, depending on what Sunday of the month it is. One way of helping to achieve this is to encourage churchwardens and others to lead non-Eucharistic worship, with guidance

and supervision from their priest. We are currently working on training, which will be delivered locally, to help achieve this.

Of course, a chunk of my work and yours is about helping our clergy to make our buildings suitable places for worship and mission. This involves, as you know, processes and procedures under the Faculty Jurisdiction Measure, which can seem quite onerous. The fact that we have this process at all is a sign that the Church, as a whole, is largely trusted with getting on with caring for its buildings. Soon it will be possible to apply for faculties online and there is a new, more extensive list of works, which is being prepared nationally, which will not require a full faculty process and which will be handled by archdeacons. These two advances should make things easier at parish level. I have, I hope, responded to your many queries and questions in this area as helpfully as possible, using the 'rules' of two historic dioceses, and I am very grateful to Judy Mason, my PA, for handling much of this on a day-to-day basis.

I look forward to working closely with more of you this coming year as we seek to commend Christ and his love for our people and communities in which we seek to exercise our ministry together.



The Ven. Paul Slater





Masters of our own destiny? Archdeacon Paul Hooper writes...

Various churches in the Leeds Area host telecoms or mobile phone operators' apparatus on or within a church tower. The mobile phone operator (such as Vodafone, O2, EE, Three, Airwave etc) is a 'tenant' of the church and occupies under a formal lease paying an annual rent.

Operators often apply to the church to obtain consent to change or upgrade the equipment installed or vary the terms of the lease/licence to allow such changes, for example, installing additional antennas or radio cabinets. DAC and specialist advice should be sought in all cases.

At The Venerable Bede Church, Wyther, Leeds, O2 attempted to undertake substantial upgrade works, which they suggested were allowed under their lease. The priest-in-charge and PCC wisely consulted a specialist surveyor to review the situation and advise them. Negotiations were conducted, resulting in a new lease with an associated increase in the rent from £5,990 per annum to £13,800 per annum!

The diocese is considering the possibility of establishing a formal arrangement with one or more specialist surveyors. In the meantime, in Leeds I can recommend **Andrew Cranston**, Director of Cell:cm Chartered Surveyors. He has helped churches in our area and can be contacted on **0191 2755009, 07834 687731** or **andrew.cranston@cellcm.co.uk**



The Ven.
Paul Hooper

Leeds Episcopal Area... Here to help...

Canon Kingsley Dowling is the Leeds Area Urban Parish Development Officer. Here he talks with The Venerable Paul Hooper, Archdeacon of Leeds

Kingsley, why did you take on this role?

Before ordination I worked in marketing and strategic planning. I have been a vicar in south Leeds for 14 years and for five years I was Area Dean of Armley, where some of the parishes are among the most deprived in the country. This role allows me to use my skills and experiences across the city.

What are your priorities for this work?

I am enthusiastic about Mission Action Planning (helping parishes develop a documented plan to fulfil their mission priorities). In some of the more challenging parishes, ministry can be lonely work, so I want to be alongside them and support them as best I can.

What has most encouraged you since taking on the role?

I have been encouraged by the enthusiasm and commitment of parishes. I have seen a real determination to make a difference to the lives of those who are living in some of our most deprived areas. It's heartening to



see Jesus's call to service being responded to in such a way.

And the challenges?

The challenges are many, not just around the demands of ministering in deprived areas, but there's also the whole question of parishes remaining viable in the short term and sustainable into the future.

Where is support and help to be found to meet the challenges?

Do come along to the Leeds Urban Parish Support Group! Nationally there are bodies like the National Estate Network offering support and there are funding bodies such as the Church Urban Fund. Or contact **Kingsley Dowling** on **0113 263 8867** or by email: **kingsley.dowling@hotmail.co.uk**

Welcoming 165,000 new parishioners

Nick Flood, a Senior Engineer with Leeds City Council and Lay Chair of Allerton Deanery, writes...

Leeds is growing. As a result of local economic growth, the number of people coming to work in Leeds is expanding and so is the need for houses.

The council has allocated sites for 66,000 new homes to be built between 2012 and

2028. That's equivalent to a population increase of approximately 165,000, bringing the city's population to about 900,000.

70% of the new homes will be on infill sites in existing built-up areas, mostly on previously developed brownfield sites. The remaining 30% will be mostly on greenfield sites. 11,300 will be in the city centre, 11,500 in the inner city and 10,000 in East Leeds. Some of these new homes are currently under construction and some have already been built.



Local services, including churches, will have to expand to keep up. The health service in Leeds will need to find about 90 more GPs and about 16,500 more primary school places, and 6,600 more secondary school places will be needed. We need to start planning now for how best we can meet the challenge of 165,000 new parishioners!!

Huddersfield Episcopal Area:



The Venerable Dr Anne Dawtry has asked two of the clergy from the Huddersfield Episcopal Area to write about how they used the opportunity of the Tour de France coming to West Yorkshire to do mission in the community...



Le Tour pedals through our parishes!

The Revd Cathy Reardon from the Eringden Benefice in Calderdale writes...

One sunny Sunday morning in July 2014, my walk down to St Michael's Mytholmroyd was unusually, almost eerily, quiet. Not a car to be seen on the usually busy Burnley Road, a few people were wandering around in garish outfits and a couple of pensioners were sitting on deckchairs at a (usually busy) junction. It was the calm before the storm: within a couple of hours the roads would be heaving with pedestrians and cyclists.

The long-awaited day of Le Tour coming through Calderdale had finally arrived. St Michael's was fortunate to be on the route – a not-to-be missed opportunity for showing God's love and hospitality to our visitors.

The evening before, we had enjoyed a French Evening in the Church Hall with cheese and wine from the continent and boules for the children outdoors. Many parishioners, including ourselves, had family and friends staying with them and so the tickets were soon snapped up. But the main event was the following day.

By 7.30am the hall and the carpark in front of it were already a hive of activity. The unmistakable aroma of frying bacon was wafting over the village. By 10am we had sold out of the bacon butties and were getting ready the hot beef and pork sandwiches, as well as cold sandwiches.

A friend from a neighbouring parish had brought a stall of home-made cakes to sell for our church funds. Such kindness! Of course tea and coffee were available all day – not to mention the bar being open.

Hospitality comes in many forms. The church was open of course, with people around to talk if anyone wanted to. Although, perhaps one of the most appreciated things we offered was free use of the toilets! I know that sounds odd, but actually the baby-changing and disabled facilities were much valued. Another way we were able to serve was by offering a room for the police to chill during their rest periods. Again much appreciated.

So was the day successful? Yes, absolutely; in terms of food and drink sold it was a roaring success. But more importantly, we were able to show friendship and care. We didn't do anything fancy or special, we just served a need and showed God's love.

The Revd Stephen Gott from the Emmanuel Team, Huddersfield writes...

The Emmanuel Team, Huddersfield (South Crosland, Armitage Bridge & Newsome) and local Methodist churches, Newsome South and Netherton, came together and celebrated



the Tour de France's grand depart in Yorkshire in style during the weekend of 5 and 6 July. Prior to the event, a number of people from the churches and members of the community got together to do some cleaning up along Woodhead Road in an effort to make part of the route tidier for the day.

On the Saturday evening at St Paul's, Armitage Bridge we welcomed Jamie Jones-Buchanan from the Leeds Rhinos who was speaking about being a Christian in sport with the chaplain of the Batley Bulldogs, Derek Ventress. We then enjoyed a quiz and a fabulous supper before being amazed and entertained by TV magician and comedian John Archer.

On Sunday, when Le Tour came along Woodhead Road, we had a drinks station at Waingate where we handed out 1,600 free sports bottles on which the slogan 'Water of Life' was printed. These bottles were filled (and then refilled) with mineral water supplied by Bronte Water in Honley. There was also the opportunity to compete for a fast time on our exercise bikes.

Back at St Paul's, our 'feeding station' supplied hungry spectators with sausage and bacon rolls, delicious homemade cakes, and hot and cold drinks. St. Paul's was also popular for those who wanted to watch the race on a giant screen in the church, and also for our toilet facilities!! All in all it was an amazing weekend, enjoyed and shared in by churches and community alike. Although our church services had to be cancelled on the Sunday, our yellow-shirted volunteers enjoyed fellowship and gave glory to God in a different way while serving our local community.

The Ven. Dr Anne Dawtry



Bradford Episcopal Area:

The Venerable Dr David Lee, Archdeacon of Bradford and Chairman of the DAC, writes about: The Mission of God and a Very Hard Question.



Jesus Christ calls the Church to participate in 'the mission of God' – this is our end as it is our beginning, it is what we are created for. 'Mission' is the context for all our worship, service and witness – it sets the scene and the direction of travel. Our God is 'the God who loves to save' and our churches are called to live that out through the transformation of the local community and by welcoming those who respond to the Holy Spirit's call. Over the ten years or so that I have served as Archdeacon of Bradford, the mission dimension has come to the fore – the word 'mission' now appears as many times at the DAC as it does at the Diocesan Mission and Pastoral Committee (!) and I expect that mission will feature even more in the next ten years.

The greatest resource of the Church of England is the people who throng our churches seeking to be a worshipping community called to express the love of God to our wider communities. One of our great assets is the church building – at least, in most cases. There are some for whom the building has become a

worry and a heavy responsibility. What is the future for these buildings and the congregations who care for them? I suggest that the 'mission' context helps us to address the hardest question a congregation will ever face – does our church building have a future and, if not, has the time come to close and relocate to a new build or a community space? One churchwarden told me: "We haven't got time for mission and outreach – all we can do is fundraise to keep out the rain."

Church buildings were built and developed within social networks, and as churches are often some of the oldest buildings in our community, they have many stories associated with them. These stories tell of how people wrestled with God (or sometimes didn't!). In fallible ways, people have drawn close to God in these buildings and have seen God draw close to them, answer prayer and bring blessing. 'We were married there 60 years ago.' Yet do we need this particular building to tell these stories or can memories re-locate to another place when the Christian community moves?



The impression a church building makes on passers-by is complex. Physical attributes – size, style, condition and location – intertwine with social attributes such as 'associations', reputation and personal experience. How much is our building a 'sign' of the bigger picture of 'the God who loves to save'? Church buildings speak all the time – they are never silent. Tired, poorly maintained, cash strapped and anachronistic are qualities which are the exact opposite of the gospel of hope for today and tomorrow. Some parishes face an extra question: how would 'other faith' communities interpret the closure of the church building? If we are to relinquish our present building, it should be done in ways that do not leave a 'church-shaped' building still speaking of decline and decay. Imaginative development or demolition are both preferable for the mission of God.

What does our church building convey about the future? Does the building point forward with hope and expectancy? A 19th-century building can look to the future through displays, reordering and the imaginative use of space and light and colour. Yet for some buildings, the scale of these adaptations is beyond local resources, especially for smaller congregations. The buildings we inherit can aid or frustrate our mission commitment.

The paradox is that the closure of some church buildings will come not from weariness and unsustainability, but from a deeper commitment to the mission of God. Let us be thankful for all that our buildings represent – and be open to new arrangements in the future. The relinquishment of a church building can set us free to love God and our neighbour. And quite unexpectedly, it can be the way to ensure that the local congregation stays in that community – able to focus not on building maintenance, but on people and the mission of 'the God who loves to save'.



The Ven. Dr David Lee

Whilst Ecclesiastical has used reasonable endeavours to ensure that the information in this newsletter is correct at the time of publication, please note: (a) the information is not intended to constitute a definitive or complete statement of the law on any subject, (b) the information may over the course of time become incorrect or out of date; and (c) neither Ecclesiastical Insurance Office plc. nor its subsidiaries can accept any responsibility or liability for action taken or losses suffered as a result of reliance placed on the information provided in this newsletter.



For more information
call **0845 777 3322**
email information@ecclesiastical.com
visit www.ecclesiastical.com/churchmatters

Ecclesiastical Insurance Office plc (EIO) Reg. No. 24869. Ecclesiastical Insurance Group plc (EIG) Reg. No. 1718196. Ecclesiastical Life Ltd (ELL) Reg. No. 243111. Ecclesiastical Investment Management Ltd (EIM) Reg. No. 2519319. Ecclesiastical Financial Advisory Services Ltd (EFAS) Reg. No. 2046087. Ecclesiastical Services Ltd (ESL) Reg. No. 1811698. E.I.O. Trustees Ltd Reg. No. 941199. All companies are registered in England at Beaufort House, Brunswick Road, Gloucester, GL1 1JZ, UK. EIO and ELL are authorised by the Prudential Regulation Authority and regulated by the Financial Conduct Authority and the Prudential Regulation Authority. EFAS and EIM are authorised and regulated by the Financial Conduct Authority. ESL is an appointed representative of EIO who is authorised by the Prudential Regulation Authority and regulated by the Financial Conduct Authority and the Prudential Regulation Authority.